

DIMENSIONS ARE APPROXIMATE
OVERALL HEIGHT = 112"
OVERALL WIDTH WITH RUB
RAILS & FENDERETTES = 98"

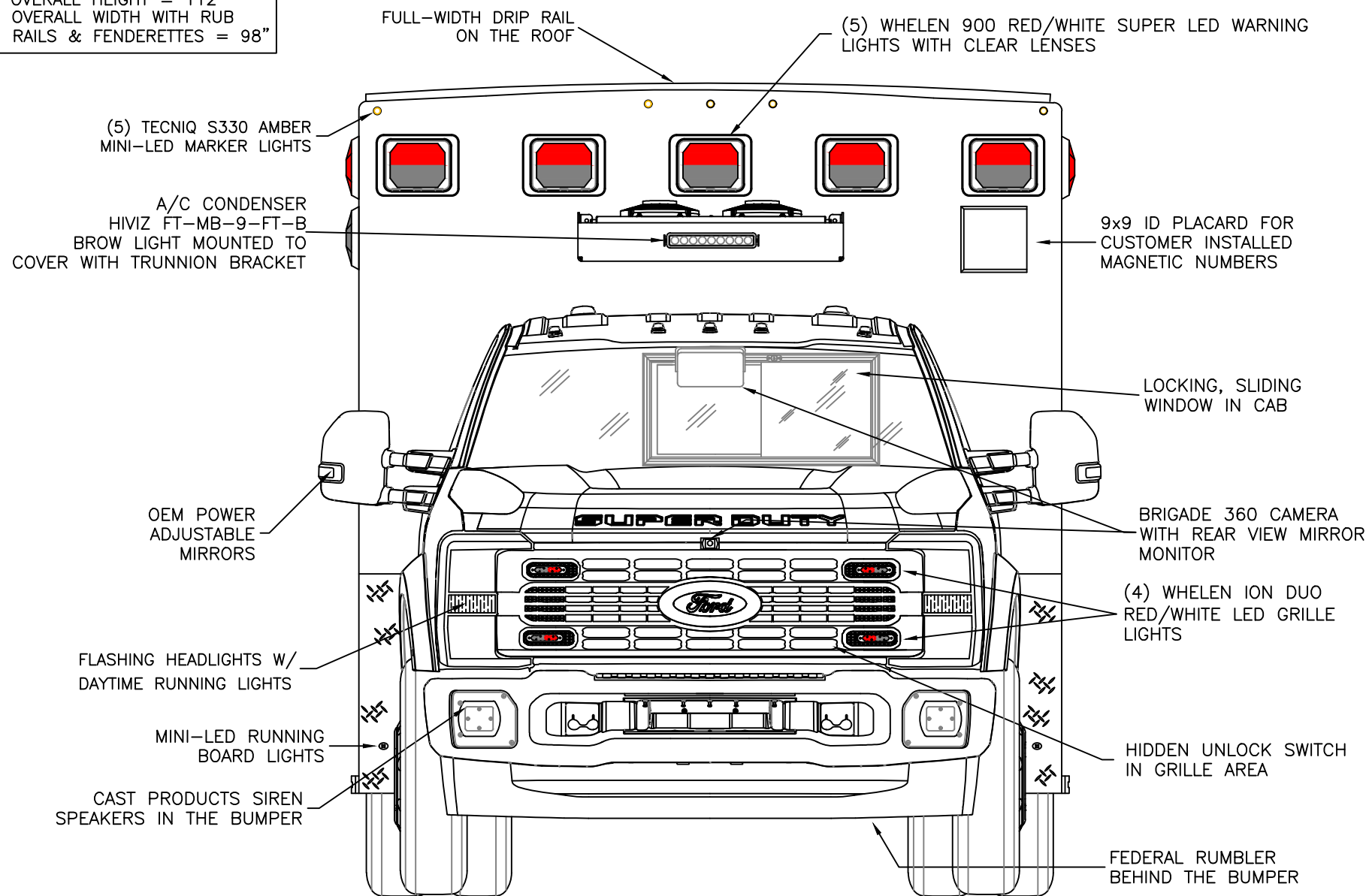

THIS DRAWING IS FOR REPRESENTATIONAL PURPOSES ONLY. DETAILS ARE CONCEPTUAL AND ARE SUBJECT TO CHANGE DURING DESIGN AND CONSTRUCTION
DIMENSIONS ARE APPROXIMATE UNLESS NOTED OTHERWISE TO MEET A SPECIFIC CUSTOMER NEED.

DURHAM COUNTY

FRONT EXTERIOR VIEW
BRAUN LIBERTY TYPE-I / F550 4X4 SUPER CAB CHASSIS

DATE:
9-17-24
DWG.
BT
REV.
B

DRAWING NO.
CPQ# 10361
DURHAM-1

APPROVAL SIGNATURE:

DATE:

DIMENSIONS FOR OVERALL HEIGHT AND LENGTH ARE APPROXIMATE
 OVERALL HEIGHT = 112"
 OVERALL WIDTH WITH RUB
 RAILS & FENDERETTES = 98"

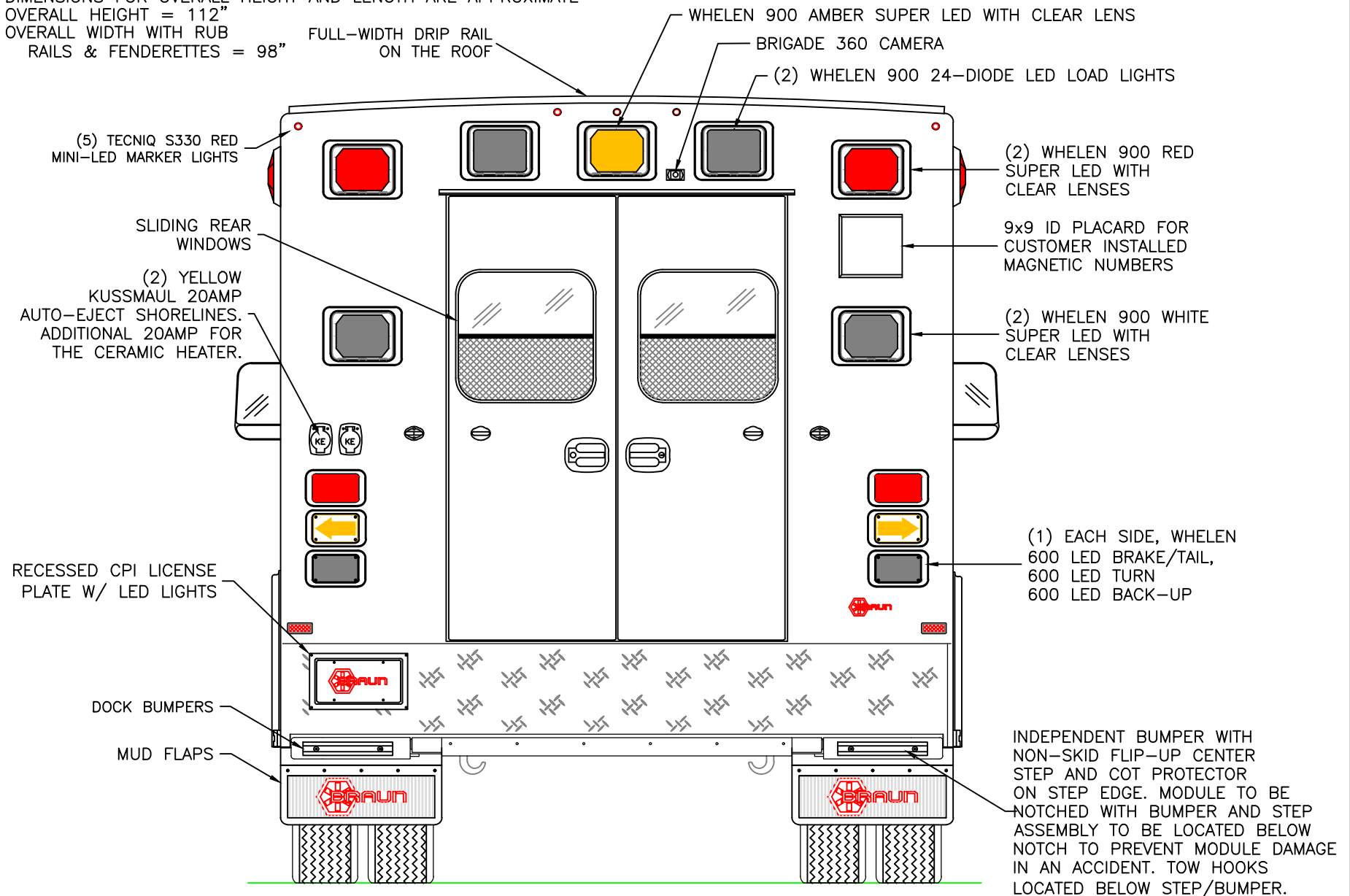

THIS DRAWING IS FOR REPRESENTATIONAL PURPOSES ONLY. DETAILS ARE CONCEPTUAL AND ARE SUBJECT TO CHANGE DURING DESIGN AND CONSTRUCTION
 DIMENSIONS ARE APPROXIMATE UNLESS NOTED OTHERWISE TO MEET A SPECIFIC CUSTOMER NEED.

DURHAM COUNTY



REAR EXTERIOR VIEW
 BRAUN LIBERTY TYPE-I / F550 4X4 SUPERCAB CHASSIS

DATE: 8-2-24
 DWG. TKD
 REV. A

DRAWING NO. CPQ# 10361
 DURHAM-2

DIMENSIONS FOR OVERALL HEIGHT AND LENGTH ARE APPROXIMATE
 OVERALL HEIGHT = 112"
 OVERALL LENGTH = 294"
 MODULE LENGTH = 156"

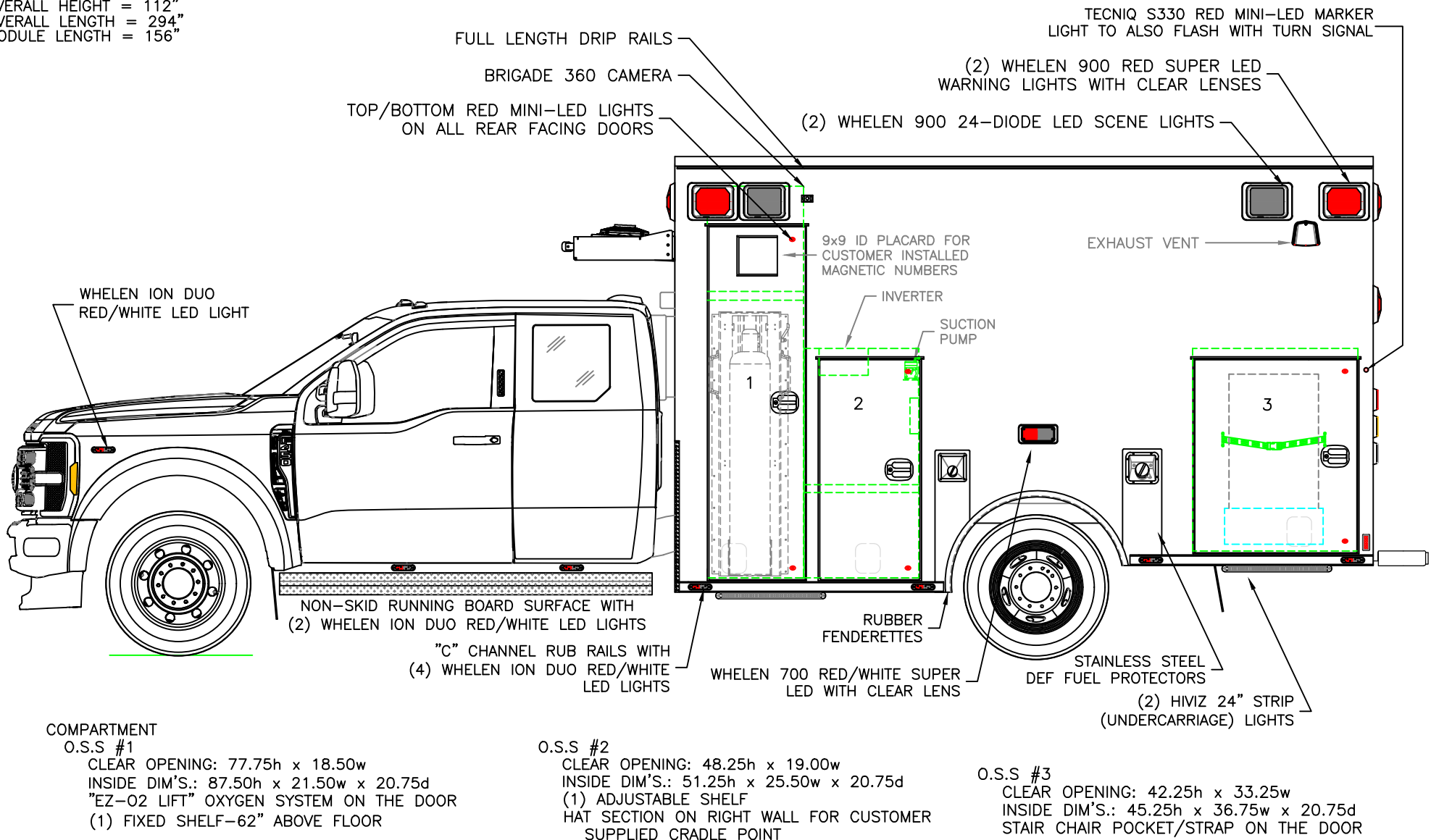

THIS DRAWING IS FOR REPRESENTATIONAL PURPOSES ONLY. DETAILS ARE CONCEPTUAL AND ARE SUBJECT TO CHANGE DURING DESIGN AND CONSTRUCTION
 DIMENSIONS ARE APPROXIMATE UNLESS NOTED OTHERWISE TO MEET A SPECIFIC CUSTOMER NEED.

DURHAM COUNTY



STREETSIDE EXTERIOR VIEW
 BRAUN LIBERTY TYPE-I / F550 4X4 SUPERCAB CHASSIS

DATE: 8-2-24	DRAWING NO. CPQ# 10361
DWG. TKD	REV. A DURHAM-3

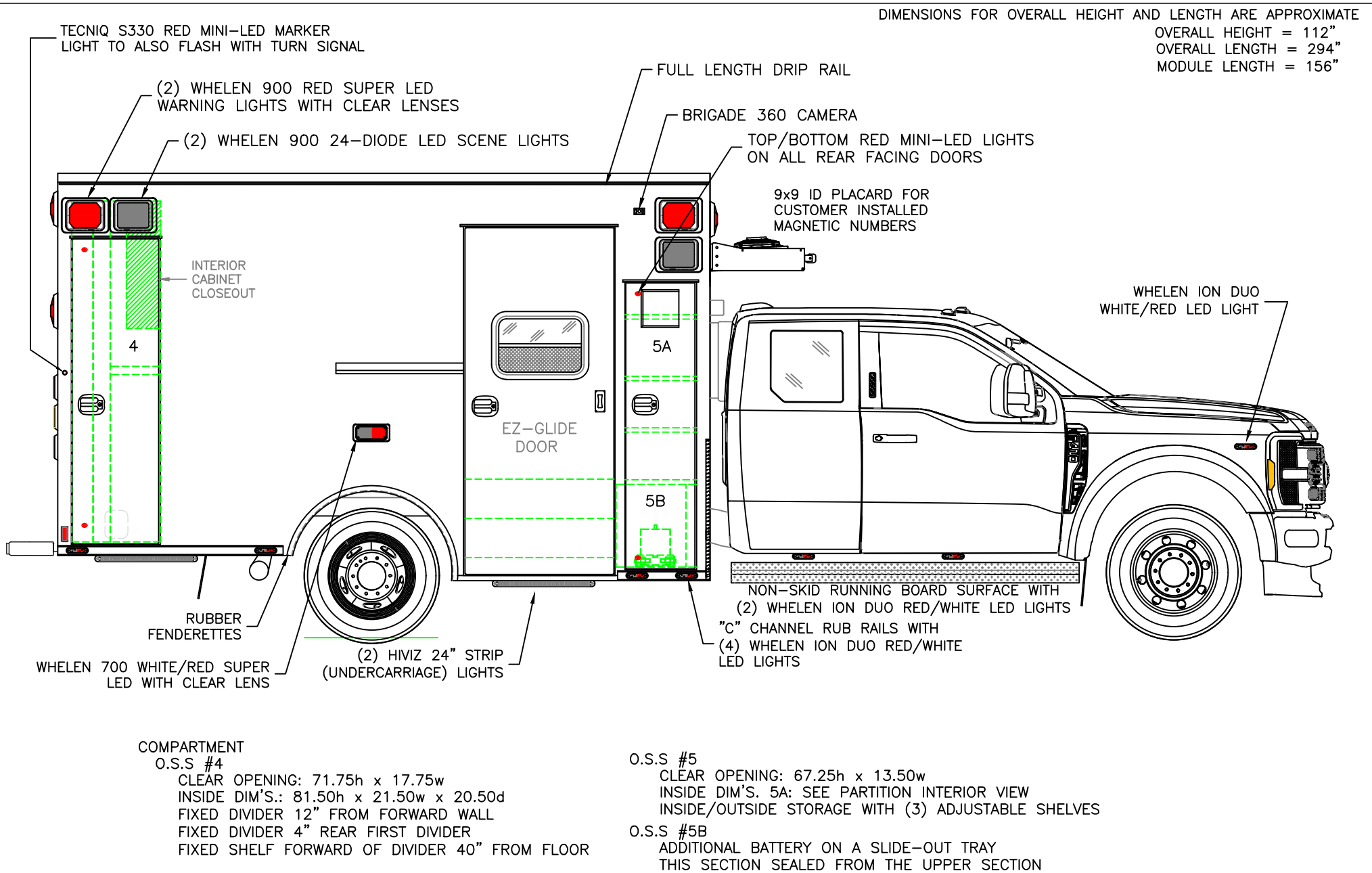

THIS DRAWING IS FOR REPRESENTATIONAL PURPOSES ONLY. DETAILS ARE CONCEPTUAL AND ARE SUBJECT TO CHANGE DURING DESIGN AND CONSTRUCTION
 DIMENSIONS ARE APPROXIMATE UNLESS NOTED OTHERWISE TO MEET A SPECIFIC CUSTOMER NEED.

DURHAM COUNTY



CURBSIDE EXTERIOR VIEW
 BRAUN LIBERTY TYPE-I / F550 4X4 SUPERCAB CHASSIS

DATE:
8-2-24
DWG. TKD

DRAWING NO.
CPQ# 10361
DURHAM-4

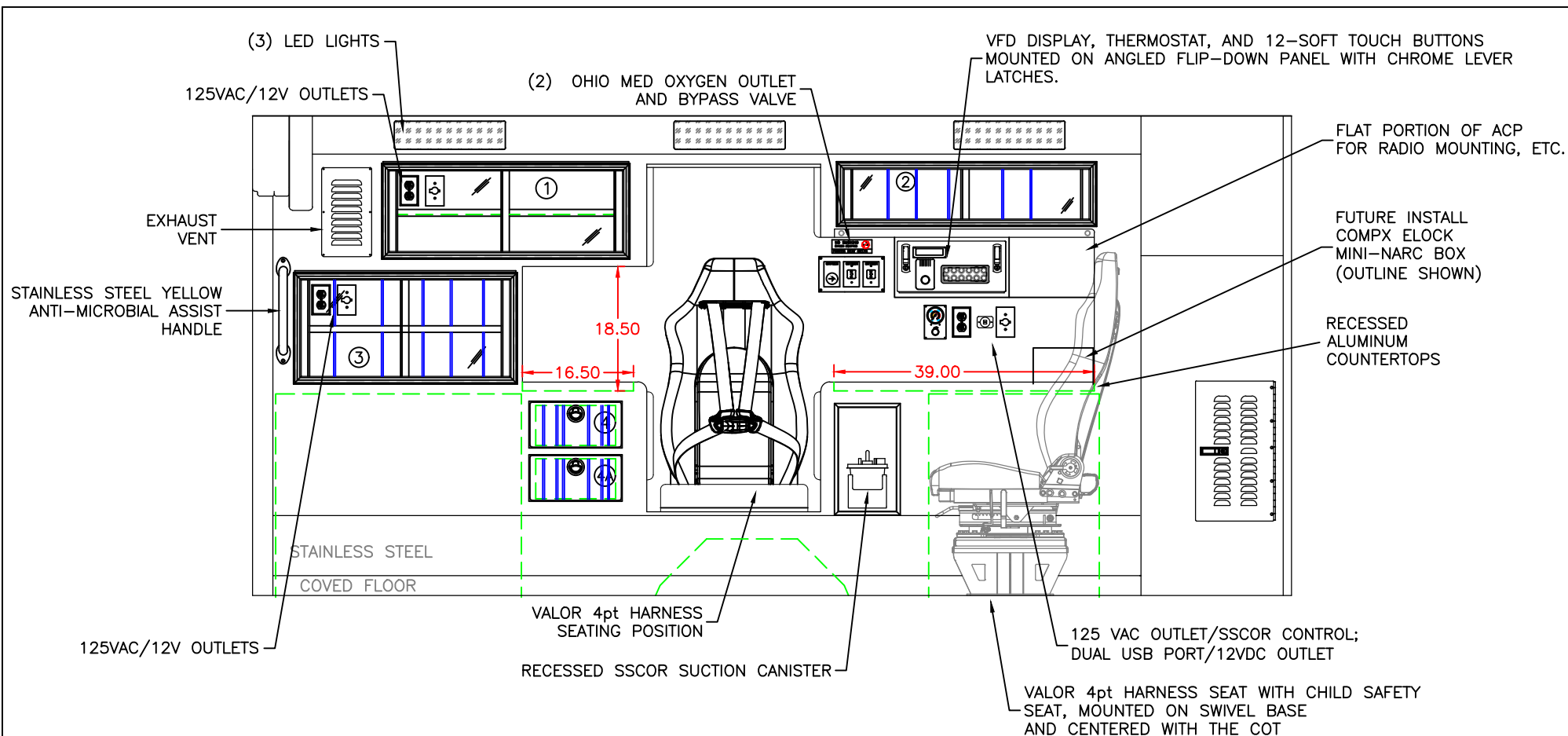

COMPARTMENT

#1 DOOR OPENING: 12.00h x 35.00w
 INSIDE DIMS: 14.25h x 36.75w x 17.25d
 (1) ADJUSTABLE SHELF
 SLIDING POLYCARBONATE DOORS
 TOTAL CABINET WEIGHT RATING = 25 lbs.

#2 DOOR OPENING: 7.50h x 36.75w
 INSIDE DIMS: 9.00h x 38.25w x 17.25d
 (1) ADJUSTABLE SHELF
 RESTOCKING, SLIDING POLYCARBONATE DOORS
 (5) ADJUSTABLE DIVIDERS
 TOTAL CABINET WEIGHT RATING = 15 lbs.

#3 DOOR OPENING: 14.50h x 31.25w
 INSIDE DIMS: 16.75h x 33.00w x 17.25d
 FIXED HORIZONTAL DIVIDER, W/(5) ADJ. DIVIDERS TOP/BOTTOM
 SLIDING POLYCARBONATE DOORS
 TOTAL CABINET WEIGHT RATING = 25 lbs.

#4, #4A = TWO DRAWERS THAT PULL-OUT TOWARD COT
 INSIDE DIMS: 6.00h x 12.00w x 14.00d
 LOCKING STAINLESS STEEL FLUSH PULL LATCHES
 (6) ADJ. DIVIDERS IN EACH DRAWER
 TOTAL DRAWER WEIGHT RATING = 10 lbs. EACH

INVENTORY CONTROL SYSTEM
 RESTOCKING FRAME ON CABINET #1-#2-#3

THIS DRAWING IS FOR REPRESENTATIONAL PURPOSES ONLY. DETAILS ARE CONCEPTUAL AND ARE SUBJECT TO CHANGE DURING DESIGN AND CONSTRUCTION
 DIMENSIONS ARE APPROXIMATE UNLESS NOTED OTHERWISE TO MEET A SPECIFIC CUSTOMER NEED.

DURHAM COUNTY



STREETSIDE INTERIOR VIEW
 BRAUN LIBERTY TYPE-I

DATE: 8-17-24	DRAWING NO. CPQ# 10361
DWG. BT	REV. B
DURHAM-5	

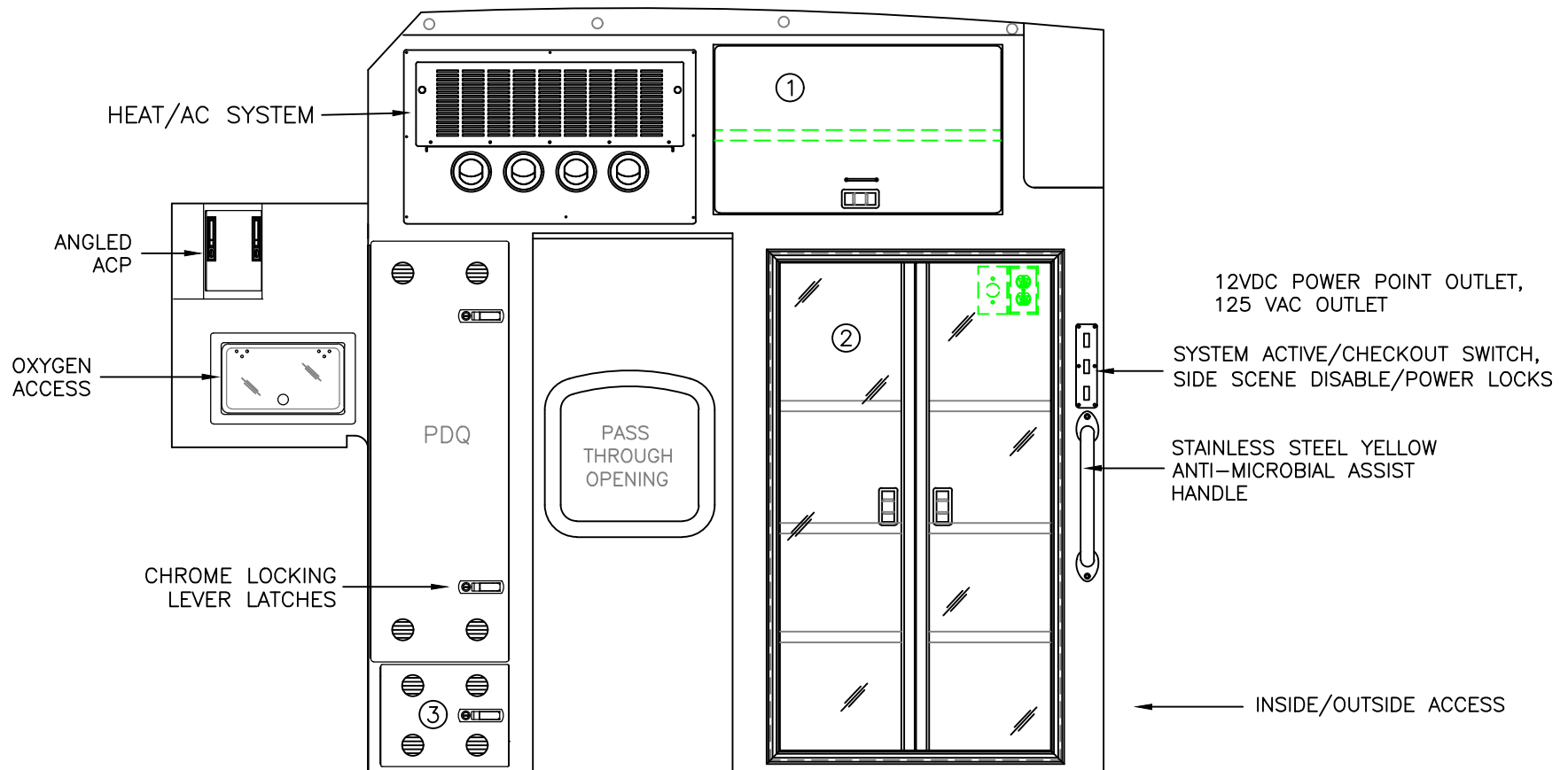

COMPARTMENT

#1 DOOR OPENING: 16.00h x 27.25w
 INSIDE DIMS: 16.00h x 27.25w x 20.50d
 (1) ADJUSTABLE SHELF
 TOP-HINGED ALUMINUM DOOR WITH "D" HANDLE,
 WITH CENTER SQUEEZE LATCH
 TOTAL CABINET WEIGHT RATING = 10 lbs.

#2 DOOR OPENING: 46.00h x 25.75w
 INSIDE DIMS: 50.00h x 31.50w x 21.50d
 HINGED POLYCARBONATE DOORS WITH FULL LENGTH
 HANDLES AND CENTER SQUEEZE LATCHES
 (3) ADJUSTABLE SHELVES
 TOTAL CABINET WEIGHT RATING = 60 lbs.

#3 VENTED RADIO CABINET
 INSIDE DIMS: 9.00h x 11.75w x 21.25d
 HINGED ALUMINUM DOOR
 CHROME LOCKING LEVER LATCH
 TOTAL CABINET WEIGHT RATING = 20 lbs.

INVENTORY CONTROL SYSTEM

THIS DRAWING IS FOR REPRESENTATIONAL PURPOSES ONLY. DETAILS ARE CONCEPTUAL AND ARE SUBJECT TO CHANGE DURING DESIGN AND CONSTRUCTION
 DIMENSIONS ARE APPROXIMATE UNLESS NOTED OTHERWISE TO MEET A SPECIFIC CUSTOMER NEED.

DURHAM COUNTY



PARTITION INTERIOR VIEW
 BRAUN LIBERTY TYPE-I

DATE:
 9-17-24
 DWG:
 BT

REV.
 B

DRAWING NO.
 CPQ# 10361
 DURHAM-7

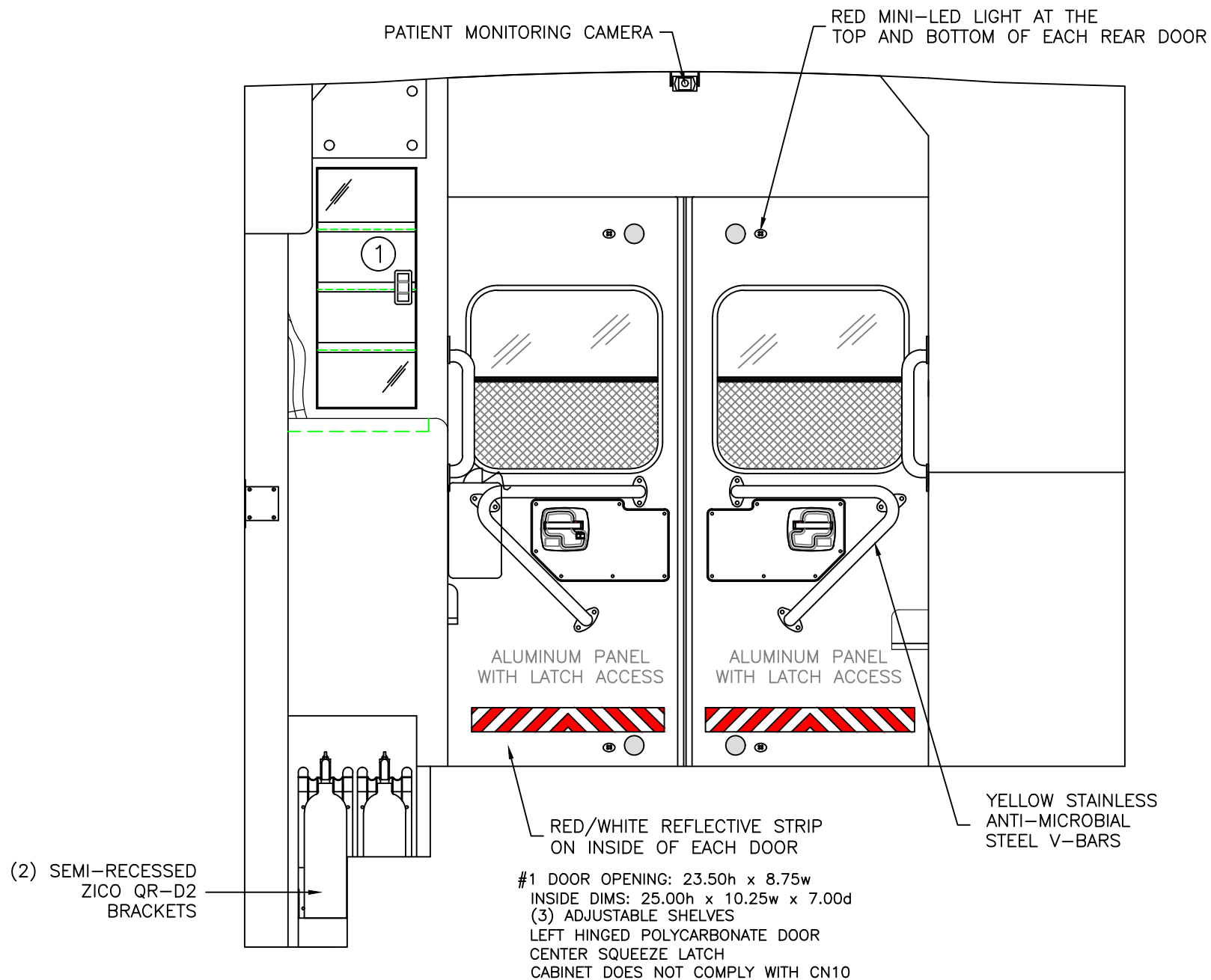

THIS DRAWING IS FOR REPRESENTATIONAL PURPOSES ONLY. DETAILS ARE CONCEPTUAL AND ARE SUBJECT TO CHANGE DURING DESIGN AND CONSTRUCTION
 DIMENSIONS ARE APPROXIMATE UNLESS NOTED OTHERWISE TO MEET A SPECIFIC CUSTOMER NEED.

DURHAM COUNTY



REAR INTERIOR VIEW
 BRAUN LIBERTY TYPE-I

DATE:
 8-2-24
 DWG. TKD
 REV. A

DRAWING NO.
 CPQ# 10361
 DURHAM-8

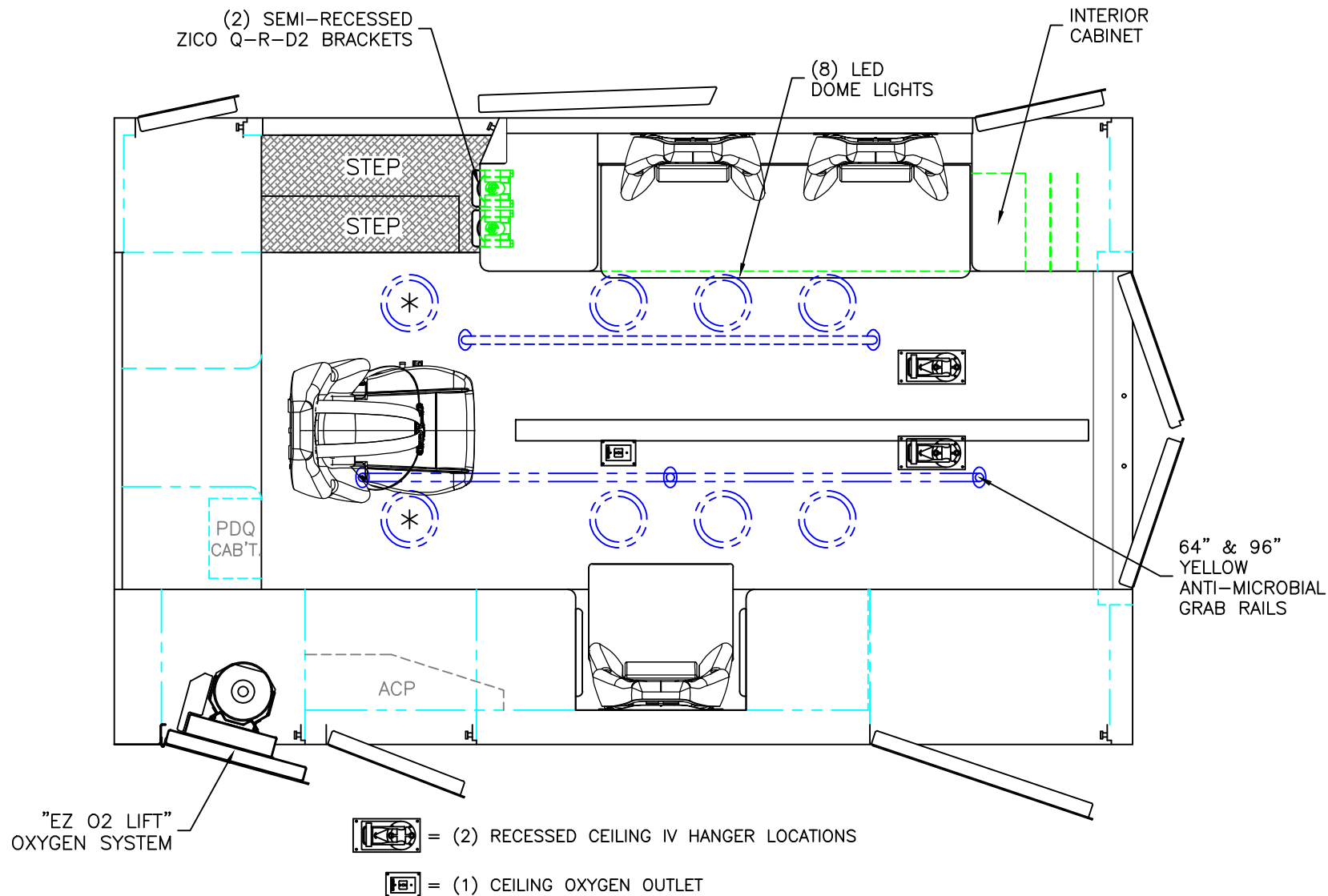

MODULE WIDTH = 96"
 MODULE LENGTH = 156"
 MODULE HEAD ROOM = 72"

THIS DRAWING IS FOR REPRESENTATIONAL PURPOSES ONLY. DETAILS ARE CONCEPTUAL AND ARE SUBJECT TO CHANGE DURING DESIGN AND CONSTRUCTION
 DIMENSIONS ARE APPROXIMATE UNLESS NOTED OTHERWISE TO MEET A SPECIFIC CUSTOMER NEED.

DURHAM COUNTY



FLOOR INTERIOR VIEW
 BRAUN LIBERTY TYPE-I

DATE:
 8-2-24
 DWG. TKD
 REV. A

DRAWING NO.
 CPQ# 10361
 DURHAM-9